

**Former Fort Ord  
Agency Meeting Schedules and Agendas**

**July 2005**

**July 20 at 1:00 p.m. – 3:30 p.m.**  
**HTW BCT Meeting**  
**BRAC Conference Room**

**July 20 at 3:30 p.m. – 5:00 p.m.**  
**HGL OUI Meeting**  
**BRAC Conference Room**

**July 21 at 10:00 a.m. – 12:00 p.m.**  
**Technical Review Committee Meeting**  
**Stilwell Community Center**

**July 21 at 1:30 p.m.**  
**MR BCT Meeting**  
**BRAC Conference Room**

**HTW BCT Meeting**  
**BRAC Conf. Room**

<b>Item</b>	<b>Action</b>	<b>Comment</b>
<b>FFA Schedules</b>	<b>Status Update</b>	
<b>OU2 and Sites 2/12 Treatment Systems</b>	<b>Status Update</b>	
<b>OUCTP RI/FS</b>	<b>Status Update</b>	
<b>Groundwater Treatment System Optimization</b>	<b>Status Update</b>	<b>Shea Homes 2/12 modifications and ESD</b>
<b>Marina Heights</b>	<b>Status Update</b>	
<b>OU2 Landfill Gas</b>	<b>Status Update</b>	
<b>Basewide Range Assessment</b>	<b>Status Update</b>	
<b>Site 39 Eco Risk Work</b>	<b>Status Update</b>	
<b>Site 3 Post Remediation Monitoring</b>	<b>Work Plan Status</b>	
<b>Range 36A Closure Activities</b>	<b>Status Update</b>	
<b>East Garrison Ranges Interim Action</b>	<b>Status Update</b>	
<b>FOST/FOSL/FOSET Issues</b>	<b>Status Update</b>	
<b>Calendar Update</b>	<b>Update</b>	
<b>Landfill use as a Habitat Area</b>	<b>Discussion</b>	
<b>OU1 Groundwater Remediation</b>	<b>Status Update</b>	<b>HGL</b>

**MR BCT Meeting**  
**BRAC Conf. Room**

<b>Item</b>	<b>Action</b>	<b>Comment</b>
<b>Fieldwork Update</b>	<b>Update</b>	
<b>Fieldwork Variance</b>	<b>Update</b>	
<b>Prescribed Burn</b>	<b>Update</b>	<b>Potential IA ROD ESC; air monitoring supplemental report</b>
<b>Track 0 Plug-In Program</b>	<b>Update</b>	
<b>Track 1 Plug-in Program</b>	<b>Update</b>	<b>MRS-6 expansion area; MRS-2; EG Area 2</b>
<b>OU2 ESD</b>	<b>Update</b>	
<b>Property Transfer</b>	<b>Update</b>	
<b>ESCA</b>	<b>Update</b>	
<b>Track 2 MR RI/FS</b>	<b>Update</b>	
<b>OU-Habitat</b>	<b>Update</b>	
<b>FFA Schedule</b>	<b>Update</b>	<b>3-month upcoming documents update</b>
<b>Action Items</b>	<b>Update</b>	

**SUBJECT: HTW - BCT Meeting**  
**July 20, 2005**  
**1:00 p.m.**

BRAC Conference Room

Check (✓)	Name	Organization	Phone	E-mail address
	Roman Racca	DTSC	916/255-6407	Rracca@dtsc.ca.gov
	Stewart Black	DTSC	916/255-3665	sblack@dtsc.ca.gov
	Dot Lofstrom	DTSC	916) 255-6449	dlofstro@dtsc.ca.gov
	John Chesnutt	U.S. EPA	415/972-3005	Chesnutt.john@epa.gov
	Martin Hausladen	U.S. EPA	415/972-3007	Hausladen.martin@epamail.epa.gov
	Grant Himebaugh	RWQCB	805/542-4636	Ghimebau@rb3.swrcb.ca.gov
	Gail Youngblood	Fort Ord BRAC	831/242-7918	gail.youngblood@monterey.army.mil
	George Siller	COE	916/557-7418	George.L.Siller@usacc.army.mil
	Peter Kelsall	Shaw E & I, Inc	831/883-5810 ext. 810	Peter.Kelsall@shawgrp.com
	David Eisen	COE	831/393-9692	David.Eisen@usacc.army.mil
	Derek Lieberman	Fort Ord BRAC	831/242-4873	Derek.Lieberman@monterey.army.mil
	Ed Ticken	MACTEC E&C	415/884-3176	ejticken@mactec.com
	Carlene Mery	MACTEC E&C	415/884-3276	cmery@mactec.com

**SUBJECT: HTW - BCT Meeting**  
**July 20, 2005**  
**1:00 p.m.**

BRAC Conference Room

Check

	Name	Organization	Phone	E-mail address
(✓)	Marc Edwards	COE	831/884-9925 ext 244	Marc.A.Edwards@usace.army.mil
	Michael Taraszki	MACTEC E&C	415/884-3325	mdtaraski@mactec.com
	Mark Fister	Ahtna	831/384-3735	mfisler@ahtna.gov
	Erik Appel	Ahtna	916/372-2000	eappel@ahtnagov.com
	Bob Parkins	HydroGeoLogic	916/614-8770	rparkins@hgl.com
	Don Jones	HydroGeoLogic	916/614-8770	djones@hgl.com
	Kris Escarda	DTSC	916/255-3651	kescarda@dtsc.ca.gov
	Bill Mabey	TechLaw Inc	415/281-8730	bmabey@techlawinc.com
	Debbie Leibman	Mactec	707 793-3857	Dilleibman@mactec.com
	Bill Collins	POM-ENV.	831 242 7920	william.collins@monterey.army.mil
	Jennifer Payne	COE	916-557-7521	jennifer.j.payne@usace.army.mil
	Roy EVANS	Hydro Geologic	303-984-1167 x5	revans@hgl.com

**DRAFT**  
**RI Sites, Former Fort Ord**

Deliverable/Event	Current Deadlines (Previous Deadlines)	Deadline Revision Rationale
<b>Site 39</b>		
Draft Basewide Range Assessment Report	7/04 (12/03)	
Comments Due	11/04 (9/04)	
Draft Final Basewide Range Assessment Report	3/05 (2/05)	
Comments Due	4/05 (3/05)	
Draft Ecological Risk Assessment for Small Arms Ranges Report	5/05 (4/05)	Additional time to incorporate comments from BCT presentation
Comments Due	7/05 (6/05)	“
Draft Final Ecological Risk Assessment for Small Arms Ranges Report	8/05 (7/05)	“
Comments Due	9/05 (8/05)	“
Draft Assessment of Soil Treatment Alternatives <del>(Supplemental Feasibility Study)</del>	5/05 (4/05)	“
Comments due	7/05 (6/05)	“
Draft Final Assessment of Soil Treatment Alternatives <del>(Supplemental Feasibility Study)</del>	8/05 (7/05)	“
Comments due	9/05 (8/05)	“
<u>Draft Supplemental Feasibility Study</u>	<u>11/05</u>	<u>More detailed FS needed after completion of the ecological risk assessment</u>
<u>Comments due</u>	<u>1/06</u>	
<u>Draft Final Supplemental Feasibility Study</u>	<u>2/06</u>	
<u>Comments due</u>	<u>3/06</u>	
Draft Proposed Plan		“

## DRAFT RI Sites, Former Fort Ord

	<u>3/06</u> (8/05) <del>(7/05)</del>	
Comments due	<u>4/06</u> (9/05) <del>(8/05)</del>	“
Draft Final Proposed Plan	<u>5/06</u> (10/05) <del>(9/05)</del>	“
Comments due	<u>6/06</u> (11/05) <del>(10/05)</del>	“
Final Proposed Plan	<u>7/06</u> (12/05) <del>(11/05)</del>	“
Public comment period	<u>8/06</u> (1/06) <del>(12/05)</del>	“
Draft ROD Amendment	<u>9/06</u> (2/06) <del>(1/06)</del>	“
Comments due	<u>10/06</u> (3/06) <del>(2/06)</del>	“
Draft Final ROD Amendment	<u>11/06</u> (4/06) <del>(3/06)</del>	“
Comments due	<u>12/06</u> (5/06) <del>(4/06)</del>	“
Final ROD Amendment	<u>1/07</u> (6/06) <del>(5/06)</del>	“
Draft Remedial Action Work Plan	<u>2/07</u> (7/06) <del>(6/06)</del>	“
Comments due	<u>3/07</u> (8/06) <del>(7/06)</del>	“
Draft Final Remedial Action Work Plan	<u>4/07</u> (9/06) <del>(8/06)</del>	“
Comments due	<u>5/07</u> (10/06) <del>(9/06)</del>	“
Draft Confirmation Report	3/09 (12/08)	
Comments due	5/09 (2/09)	
Draft Final Confirmation Report	6/09 (3/09)	
Comments due	7/09 (4/09)	

# Former Fort Ord Groundwater Treatment Systems Operational Data

Project	Status/Update
OU-2	<p><u>O &amp; M</u>      <u>Stats for the month of May (5/28/05-6/24/05)</u></p> <p>Plant operating at 838gpm (avg.) Average influent concentration of 9.0 ppb (TCE) 33.82 million gallons treated.</p> <p><u>Cumulative Stats:</u> 3.151 billion gallons of water treated</p>
Sites 2/12	<p><u>O &amp; M</u>      <u>Stats for the month of May (5/28/05-6/24/05)</u></p> <p>Plant operating at 291gpm (avg.) Average influent concentration of 14 ppb (TCE) 11.73 million gallons treated</p> <p><u>Cumulative Stats:</u> 813 million gallons of water treated</p>

#### Operational Issues:

- 1) Extraction well sampling was performed at both plants on June 20-21, 2005.
- 2) EW-12-03-180M (212 GWTS) remains off pending electrical trouble shooting.

#### Document Issues:

- 1) OU2 and 2/12 Annual Reports shipped.
- 2) Health and Safety Draft to be shipped.
- 3) OU2 and 2/12 O&M Manuals in progress.



**Summary of Carbon Tetrachloride Concentration Concentrations**

			Carbon Tetrachloride Conc. (ppbv)				Difference since last sampled (ppbv)
			Sample Dates				
PROBE ID	PROBE TYPE	FINISH DEPTH	Jun-04	Sep-04	Nov-04	May-05	
CTP-SGP-50	SURFACE	6	0.13J			<0.82	NC
CTP-SGP-53	SHALLOW	30			0.11J	0.79	0.68
CTP-SGP-65	SHALLOW	30			1	2	1
CTP-SGP-51	SHALLOW	30			<0.8	<0.8	NC
CTP-SGP-58	SHALLOW	30			<0.86	<0.8	NC
CTP-SGP-59	SHALLOW	30			0.076J	<0.8	NC
CTP-SGP-60	SHALLOW	30			<0.74	<0.8	NC
CTP-SGP-64	SHALLOW	30			0.097J	<0.8	NC
CTP-SGP-56	SHALLOW	30			<0.78	<0.84	NC
CTP-SGP-52	SHALLOW	30			0.14J	0.32J	0.18
CTP-SGP-55	SHALLOW	30			0.14J	0.63J	0.49
CTP-SGP-63	SHALLOW	30			0.44J	0.72J	0.28
CTP-SGP-62	SHALLOW	30	0.27J			0.7J	0.43
CTP-SGP-64	DEEP	85			2.6	2.3	-0.4
CTP-SGP-62	DEEP	85		0.68J		3.1	2.42
CTP-SGP-56	DEEP	85			4.4	3.8	-0.6
CTP-SGP-52	DEEP	85			0.62J	5	4.38
CTP-SGP-53	DEEP	85			6.8	5.2	-1.6
CTP-SGP-55	DEEP	85			9.2	8.2	-1
CTP-SGP-65	DEEP	85			22	17	-4
CTP-SGP-63	DEEP	85			25	24	-1
CTP-SGP-58	DEEP	85			<0.76	<0.82	NC
CTP-SGP-59	DEEP	85			0.47J	0.44J	-0.03
CTP-SGP-51	DEEP	85			0.27J	0.66J	0.39
CTP-SGP-60	DEEP	85			0.36J	0.78J	0.42

**LEGEND**

- ◆ SOIL VAPOR EXTRACTION WELL
- ▲ DEEP (80-85 FT.) MONITORING PROBE
- TEMPORARY SOIL GAS MONITORING PROBE SAMPLED MARCH TO JUNE 2003
- 280 ppbv - 7' CARBON TETRACHLORIDE CONCENTRATION - MARCH 2004
- 210 ppbv CARBON TETRACHLORIDE CONCENTRATION - MARCH 2004
- 38 ppbv CARBON TETRACHLORIDE CONCENTRATION - APRIL 2004
- 14 ppbv CARBON TETRACHLORIDE CONCENTRATION - MAY 2004
- 14 ppbv CARBON TETRACHLORIDE CONCENTRATION - JUNE-AUGUST 2004
- 5.6 ppbv CARBON TETRACHLORIDE CONCENTRATION - SEPTEMBER 2004
- 6.7 ppbv CARBON TETRACHLORIDE CONCENTRATION - OCTOBER 2004
- 2.6 ppbv CARBON TETRACHLORIDE CONCENTRATION - NOVEMBER 2004
- 2.3 ppbv CARBON TETRACHLORIDE CONCENTRATION - MAY 2005
- CARBON TETRACHLORIDE CONCENTRATION CONTOURS AT 85 FT. DEPTH (ppbv) PRIOR TO SVE OPERATION; DASHED WHERE INFERRED
- ▭ BUILDING

- NOTES:**
1. March Carbon Tetrachloride concentrations measured between 375'04 and 41'04, below SVE operation.
  2. April Carbon Tetrachloride concentrations measured 4/26/04.
  3. May 2004 Carbon Tetrachloride concentrations measured 5/1/04.
  4. June-August Carbon Tetrachloride concentrations measured 6/14, 6/17, 7/2, 7/20, and 8/4/04.
  5. September Carbon Tetrachloride concentrations measured 9/2/04 and 9/23/04.
  6. October Carbon Tetrachloride concentrations measured 10/7/04, 10/14/04, and 10/22/04.
  7. November Carbon Tetrachloride concentrations measured 11/7/04, 11/18/04, and 11/23/04.
  8. May 2005 Carbon Tetrachloride concentrations measured 5/24/05 and 5/25/05.
  9. J is a laboratory outlier (estimated value).
  10. Phase 1 SVE operation April 6 to June 14, 2004. Phase II Sept. 9 to Nov. 8, 2004.

REVISION	DATE	DESCRIPTION

**Slaw** Soave Environmental, Inc.  
 Department of the Army  
 Sacramento District, Corps of Engineers  
 Sacramento, California

DESIGNED: E. EICHMUT  
 DRAWN: M. COLEMAN  
 CHECKED: P. HILL  
 SUBMITTED: DATE: SCALE: SHEET: FILE NO.:

**FIGURE 5-5**  
**CARBON TETRACHLORIDE CONCENTRATIONS**  
**DEEP MONITORING PROBES**  
**OPERABLE UNIT CARBON TETRACHLORIDE**  
**FORMER FORT OGDEN, CALIFORNIA**

SCALE: SHEET: FILE NO.:  
 C:\trees\_May2005.dwg

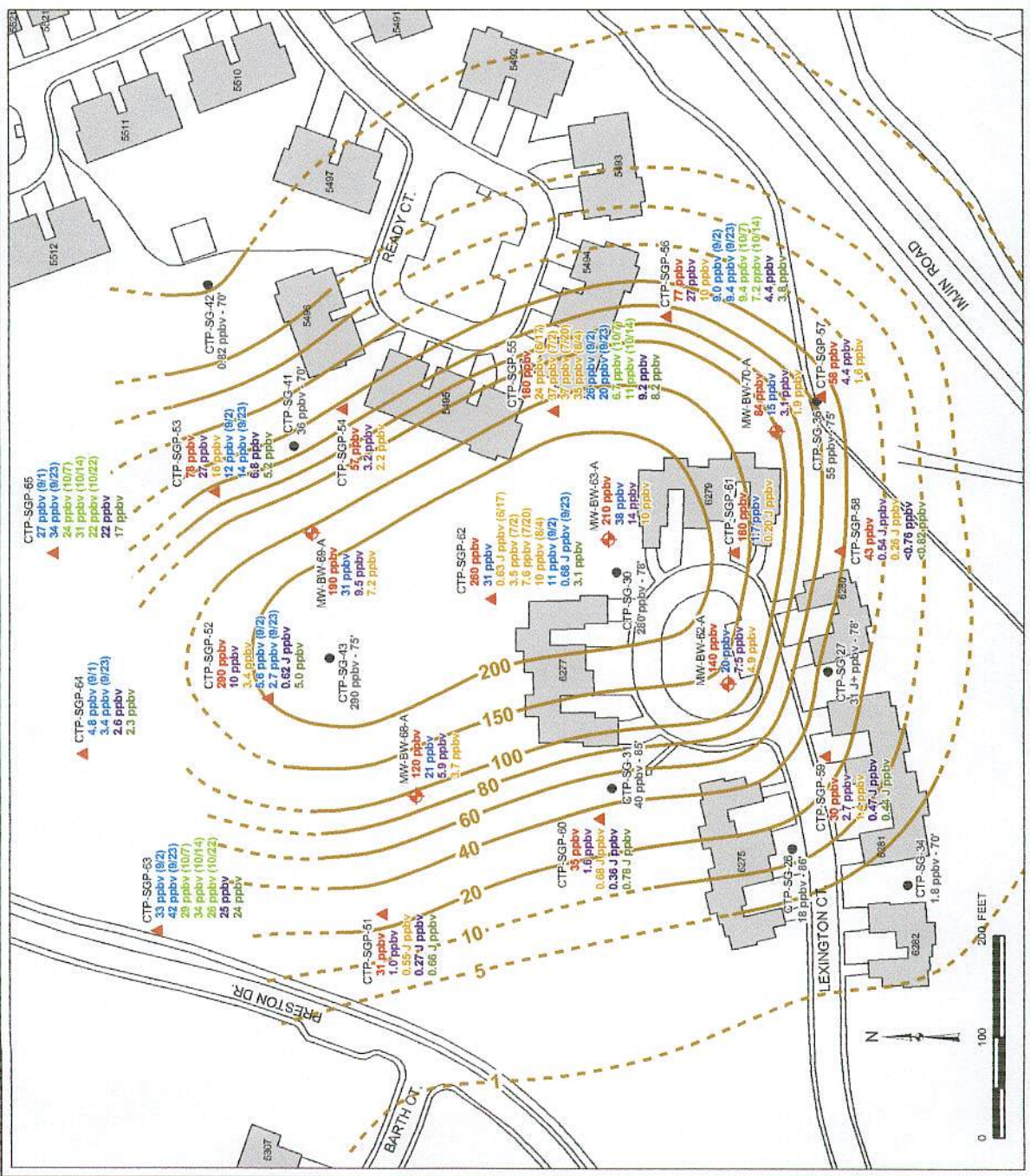

## Phase 1 Well Abandonment

### Former Fort Ord, Marina, California

Anticipated depths and screen intervals for Phase 1 wells to be abandoned are listed below:

MW ID	Total Depth (feet)	Casing Type	Casing Diameter	Screen Interval (feet)	Method of abandonment
MW-B-13-180	202	PVC	6	167-197	Overdrill/grout
MW-B-11-A	85	PVC	6	60-80	Grout/remove top 5 feet
MW-OU2-65-180	280	PVC	5	260-280	Grout/remove top 5 feet
MW-05-01-A	89.5	Stainless steel	2	69.5-89.5	Overdrill/grout
MW-05-02-A	89	Stainless steel	2	69-89	Overdrill/grout
MW-05-03-A	89.5	Stainless steel	2	69.5-89.5	Overdrill/grout

1. **MW-B-13-180** will be abandoned by overdrilling since it is a suspected vertical conduit between two aquifers. The goal of over-drilling MW-B-13-180 is to completely remove the well casing, annular seal, and sand pack material and replace it with impermeable material to reestablish the local integrity of the FO-SVA clay as an aquitard. To minimize cross contamination between the Upper 180-Foot Aquifer the A-Aquifer, MW-B-13-180 will be drilled out in two phases:

- Drill out the top 100 feet (approximately 10 feet into the SVA) using a 16-inch bit with a guide to help keep the bit centered on the casing
- Install 12-inch casing and grout in place
- Drill out remaining casing using a 12-inch bit with guide
- Grout hole using a tremie to approximately 75 feet
- Pull out 12-inch casing in 20-foot increments and continue to grout using a tremie pipe

2. **MW-B-11-A and MW-OU2-65-180** – Since MW-B13-180 is located in the UCSC habitat reserve, these two wells were included as part of Phase 1 to facilitate coordination with and complete well abandonment within the habitat reserve.

3. **MW-05- 01-A, MW-05-02-A, and MW-05-03-A** will be abandoned by overdrilling to completely remove the casing and screen constructed of 2-inch diameter stainless steel. The goal is to completely remove the stainless steel casing and screen so as not to interfere with future geophysical activities at these locations. These are located within Range 36A where subsurface geophysical MM clearance will be conducted.

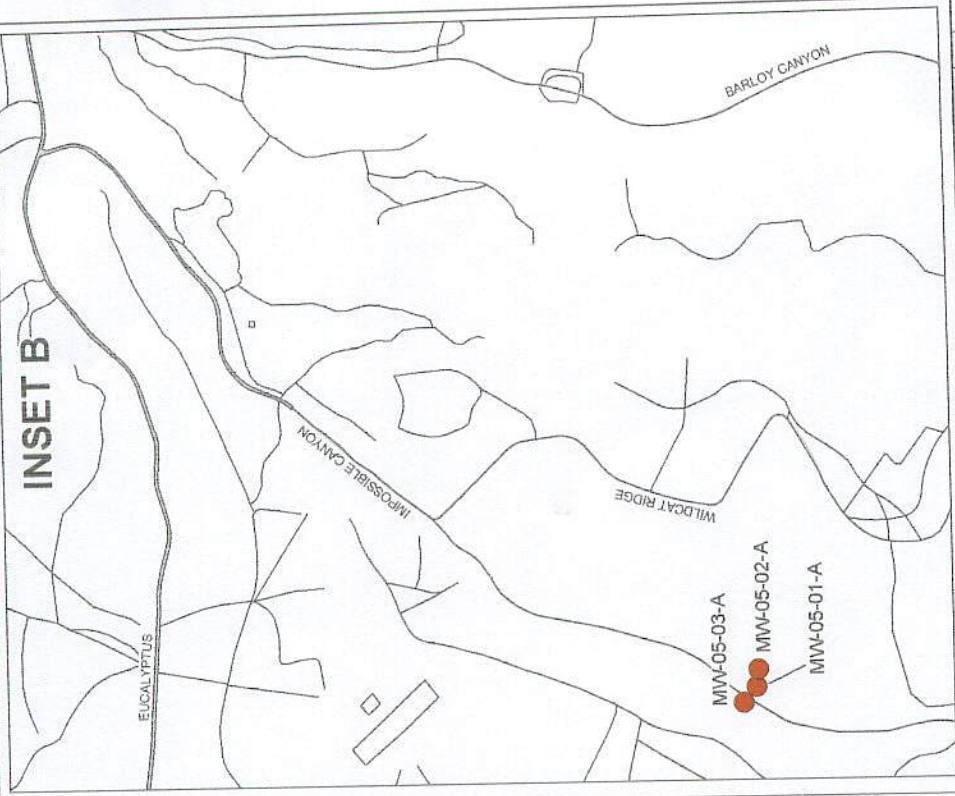
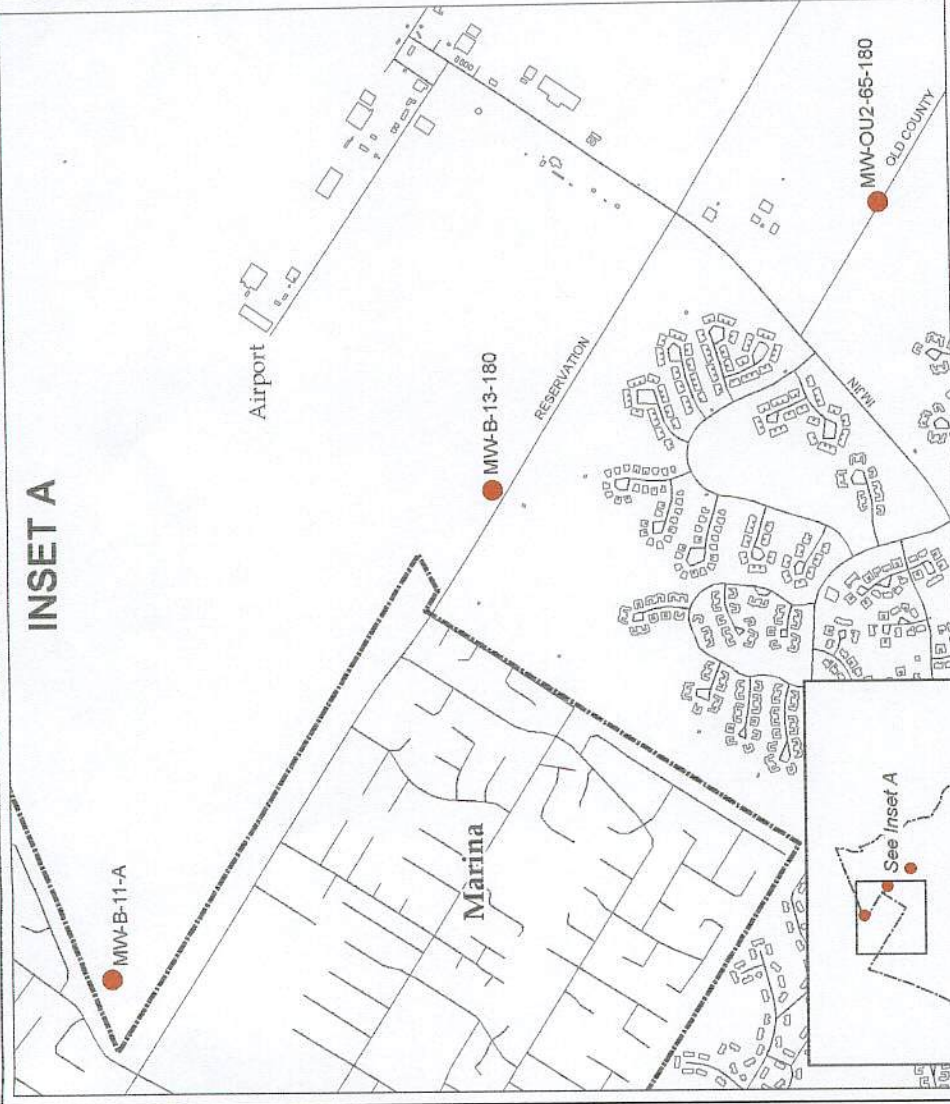

REVISION	DATE	DESCRIPTION	LOGG. APPR.
 Shaw Environmental, Inc. Department of the Army Sacramento District, Corps of Engineers Sacramento, California			
DESIGNED	J. MOSEER	FIGURE 1	
DRAWN	K. BLACK	WELLS PROPOSED FOR DESTRUCTION	
CHECKED	P. FELSALL	Former Fort Ord, California	
SUBMITTED		SCALE	DATE
		SHEET	FILE No.
			SOW.mxd

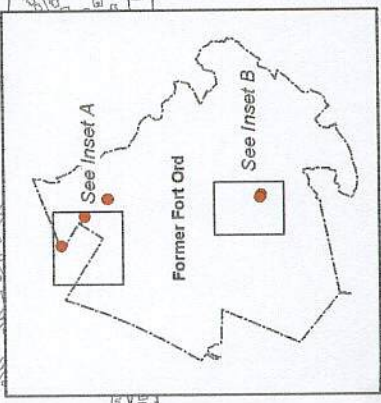
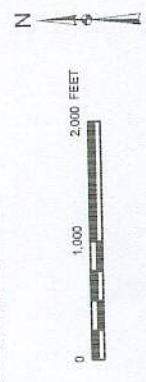

## Former Fort Ord Property Transfer Update

July 20, 2005

### FOST 8

- Track 0 and Track 0 Plug-in Group B Parcels (29 Parcels ~234 acres)
- Agencies have concurred with FOST.
- Tom Lederle signed the FOST on June 7, 2005.
- One Groundwater Protection CRUP for three parcels. CRUP language yet to be finalized with DTSC.

## FOST 9

- Track 0 Plug-in Group C, Track 1 and Track 1 Plug-in Parcels (29 Parcels ~1,894 acres)
- 30-day public comment period ended June 30, 2005. Comments from agencies.
- USEPA concerned about LFG migration/vapor intrusion in parcels adjacent to OU2 Landfills.
- Revised Army responses to comments submitted to agencies on July 20, 2005.
- USEPA concurred with Track 0 Plug-in Approval Memorandum, Group C Parcels, DTSC concurrence pending.
- USEPA and DTSC concurred with Track 1 Plug-in Approval Memorandum, MRS-6 Expansion Area.
- Five Groundwater Protection CRUPs (one per jurisdiction) for 15 parcels.

## FOST 10 (proposed)

- Track 0 Plug-in, Track 1 Plug-in and OU2 Landfills Parcels (18 Parcels ~397 acres)
- Track 0 Plug-in parcels dropped from FOST 8 and FOST 9. Will require approval memo.
- Track 1 Plug-in parcels mostly associated with MRS-2 (8 of 10 parcels ~45 acres). Will require approval memo. Also listed in FOSET 5.
- OU2 Landfills parcels require ESD addressing potential presence of MEC in the Landfills. Draft ESD returned to contractor with comments on July 8, 2005. Also listed in FOSET 5.
- Three Groundwater Protection CRUPs, one CRUP for residential restriction, one CRUP for OU2 Landfills.
- If Track 1 Plug-in parcels are not included (specifically MRS-2 related parcels), signature of FOST estimated to be March 2006. If included, signature of FOST estimated to be July 2006.

## FOSL 12

- Military Operations on Urbanized Terrain (MOUT) Site (1 Parcel ~54 acres)
- Comments received from USEPA and DTSC and Clifford Doyle. Comments expressed concern that intended reuse given in FOSL (for MPC's public safety programs) is too vague. FOSL being revised to provide specifics based on like use scenario.
- Has received low priority status due to issues with FOST 8, FOST 9 and FOSET 5.

## FOSET 5

- ESCA (67 Parcels ~4,099 acres)
- Draft FOSET complete, submitted to HFO on June 28, 2005, now in internal Army review.